



COMPETITION/PLUS[®]

INSTALLATION INSTRUCTIONS

U.S. PATENT NO. 3,216,274 & NO. 3,306,126

373 0001

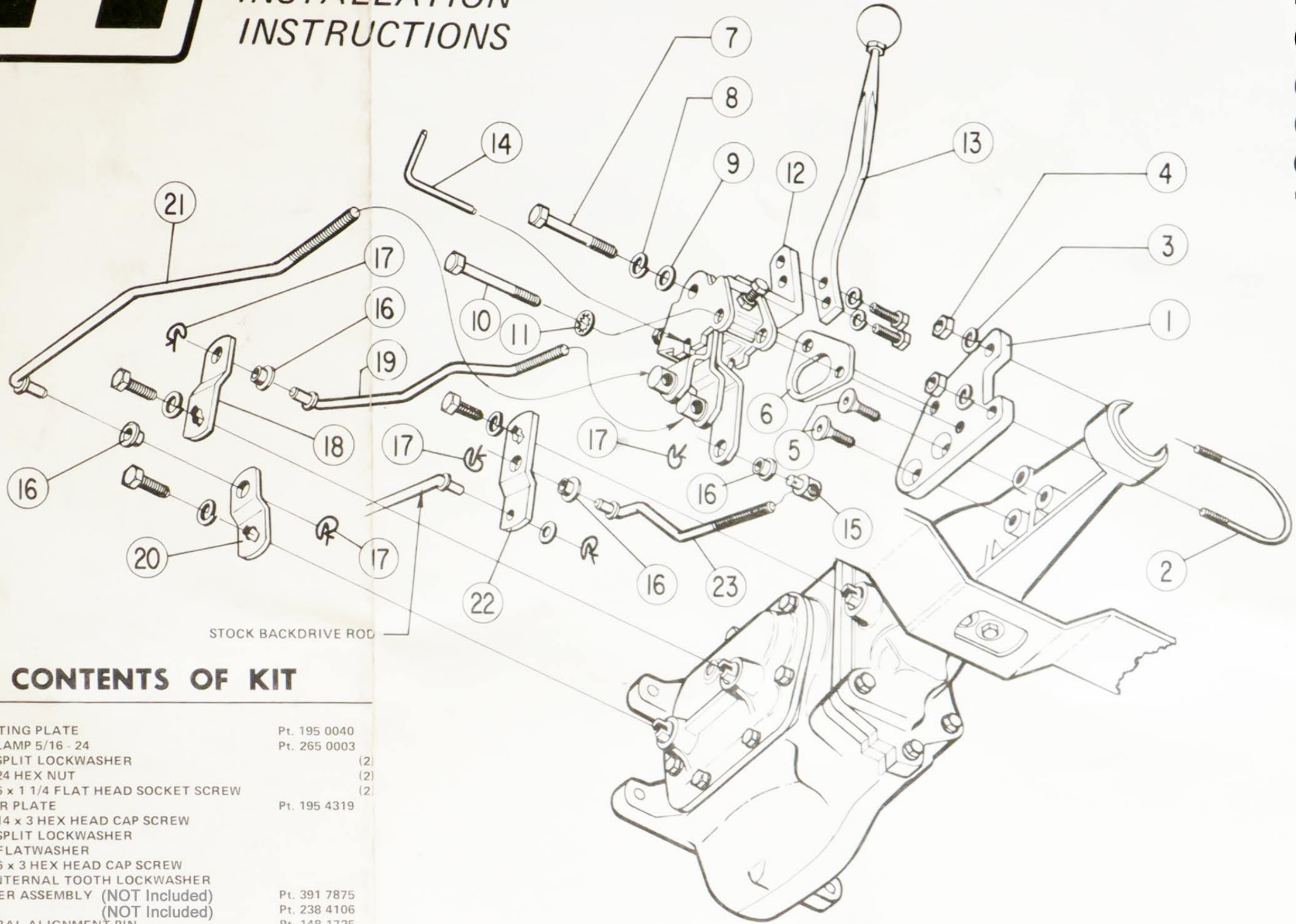

CONTENTS OF KIT

1. MOUNTING PLATE	Pt. 195 0040
2. "U" CLAMP 5/16 - 24	Pt. 265 0003
3. 5/16" SPLIT LOCKWASHER	(2)
4. 5/16 - 24 HEX NUT	(2)
5. 3/8 - 16 x 1 1/4 FLAT HEAD SOCKET SCREW	(2)
6. SPACER PLATE	Pt. 195 4319
7. 7/16 - 14 x 3 HEX HEAD CAP SCREW	
8. 7/16" SPLIT LOCKWASHER	
9. 7/16" FLATWASHER	
10. 3/8 - 16 x 3 HEX HEAD CAP SCREW	
11. 3/8" INTERNAL TOOTH LOCKWASHER	
12. SHIFTER ASSEMBLY (NOT Included)	Pt. 391 7875
13. STICK (NOT Included)	Pt. 238 4106
14. NEUTRAL ALIGNMENT PIN	Pt. 148 1725
15. ROD ADJUSTING BUTTON	Pt. 119 3783 (3)
16. NYLON BUSHING	Pt. 118 1681 (6)
17. SPRING CLIP	Pt. 127 2412 (6)
18. ARM 1st - 2nd	Pt. 105 7129
19. ROD 1st - 2nd	Pt. 213 5307
20. ARM 3rd - 4th	Pt. 105 7130
21. ROD 3rd - 4th	Pt. 213 2145
22. ARM REVERSE	Pt. 105 7128
23. ROD REVERSE	Pt. 213 3691

BAGGED HARDWARE Pt. 154 0037