

COMPETITION/PLUS

U.S. PATENT NO. 3,216,274 & NO. 3,306,126

INSTALLATION INSTRUCTIONS

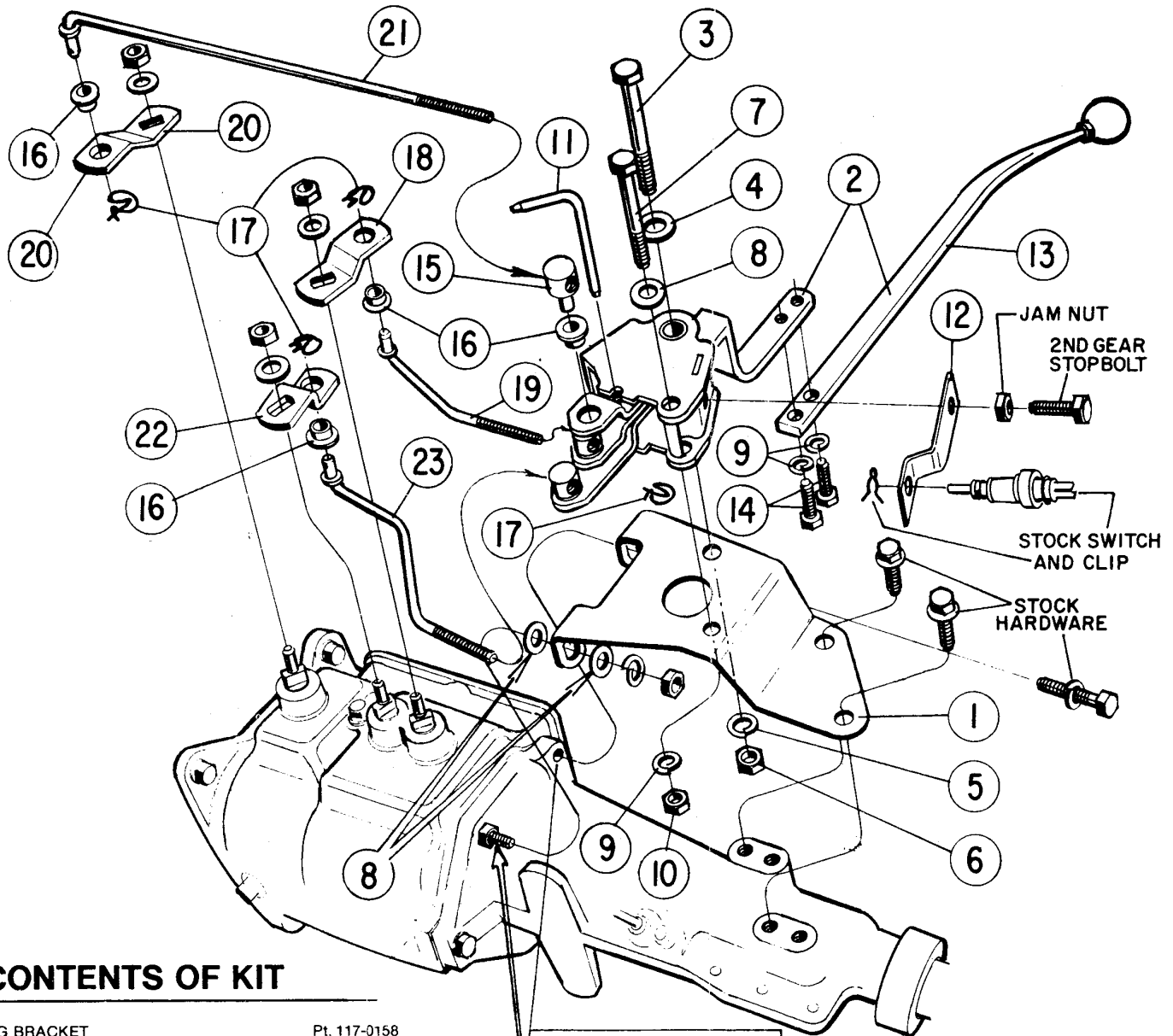

CONTENTS OF KIT

- | | |
|-------------------------------------|------------------|
| 1. MOUNTING BRACKET | Pt. 117-0158 |
| 2. SHIFTER ASSEMBLY | Pt. 391-0024 |
| 3. 7/16—14 x 3/4 HEX-HEAD CAP SCREW | Pt. 215-5649 |
| 4. 7/16" FLATWASHER | Pt. 267-3475 |
| 5. 7/16" SPLIT LOCKWASHER | Pt. 267-3466 |
| 6. 7/16—14 HEX-NUT | Pt. 179-8281 |
| 7. 3/8—46 x 3 HEX-HEAD CAP SCREW | Pt. 215-3450 |
| 8. 3/8" FLATWASHER | Pt. 267-3700 (3) |
| 9. 3/8" SPLIT LOCKWASHER | Pt. 267-3464 (3) |
| 10. 3/8—16 HEX-NUT | Pt. 179-3853 |
| 11. NEUTRAL ALIGNMENT PIN | Pt. 148-1725 |
| 12. BRACKET—BACK-UP LIGHT SWITCH | Pt. 117-0161 |
| 13. STICK | Pt. 238-0085 |
| 14. 3/8—24 x 1 HEX-HEAD CAP SCREW | Pt. 215-9038 (2) |
| 15. ROD ADJUSTING BUTTON | Pt. 119-3783 (3) |
| 16. BUSHING | Pt. 118-1681 (6) |
| 17. SPRING CLIP | Pt. 127-2412 (6) |
| 18. ARM—1-2 | Pt. 105-3894 |
| 19. ROD—1-2 | Pt. 213-0152 |
| 20. ARM—3-OVERDRIVE | Pt. 105-0070 |
| 21. ROD—3-OVERDRIVE | Pt. 213-1588 |
| 22. ARM—REVERSE | Pt. 105-0073 |
| 23. ROD—REVERSE | Pt. 213-0153 |

BAGGED HARDWARE Pt. 154-0150

373 8620