

HURST
COMPETITION/PLUS®
 U.S. PATENT NO. 3,218,274 & NO. 3,306,126
FOUR SPEED FLOOR SHIFT
INSTALLATION INSTRUCTIONS

1. Remove stock shifter, stock mounting plate and linkage.
2. Assemble arms with their respective rods using steel bushings and spring clips. Refer to exploded assembly drawing for proper combination. Spin rod adjusting buttons onto threaded ends of rods (up about half way on threaded length).
3. Install HURST mounting plate.

NOTE: If back-up light switch bracket (Pt. 1176889) is used, install it on shifter before mounting shifter on mounting plate. See exploded assembly view. This bracket is designed to use Ford switch, FoMoCo Pt. No. COAZ-15520-A. This switch IS NOT supplied with kit. Use the 7/16 - 20 x 1/8 nut supplied to fasten the switch to bracket.

4. Install shifter on mounting plate with bolts supplied. Insert bushings into holes in levers - refer to assembly view. Align levers with shifter frame and insert neutral alignment rod (Pt. 148 1725) through notches in frame and holes in lever.
5. Rotate transmission arms backward and forward. The neutral position for each arm can be felt at the mid-position of full travel. Reverse arm must be moved to the end of its travel toward the front (disengaged position). Transmission arms must remain in neutral positions while alignment is accomplished.

6. Install arm/rod assemblies on transmission shafts. Adjust position of buttons on rods to allow an easy slip-in fit of button into steel bushing in each respective shifter lever. Install 1-2 arm/rod, then 3-4 arm/rod and finally, the reverse arm/rod assembly. Refer to the exploded assembly drawing for proper combination. Remove the neutral alignment pin after all buttons have been secured with spring clips.

7. Test shifter. Stick should move freely from side to side at neutral (between 1-2 and 3-4 shifting paths). An increased pull toward the operator should engage the reverse lever. If shifter functions properly, proceed to paragraph 8.

If the stick CANNOT be moved freely between 1-2 to 3-4 or reverse path, one or more of the rod button adjustments must be corrected. Move stick forward to 3rd, then back to 4th, then into neutral. Insert neutral alignment rod. If rod CANNOT be inserted freely, the 3-4 rod button is incorrectly adjusted. Similar testing of 1-2 shift will prove alignment of 1-2 rod adjustment.

To check reverse rod button adjustment, place stick at neutral. Disconnect reverse rod adjusting button from reverse lever. Grasp rod and push toward front of car. (Reverse arm is disengaged when at end of forward travel.) Adjust rod button for easy slip in fit in bushing. Re-assemble and fasten with spring clip.

8. Adjust shifter stop bolts. Back both bolts out of shifter frame until only a few threads remain engaged. Push stick firmly into 3rd gear and hold. Screw 3rd gear stop bolt in until contact is felt. Back bolt out one turn and tighten locknut. Pull stick firmly back into 4th gear screw 4th gear stop bolt in until contact is made, then back stop bolt out one turn and tighten locknut.

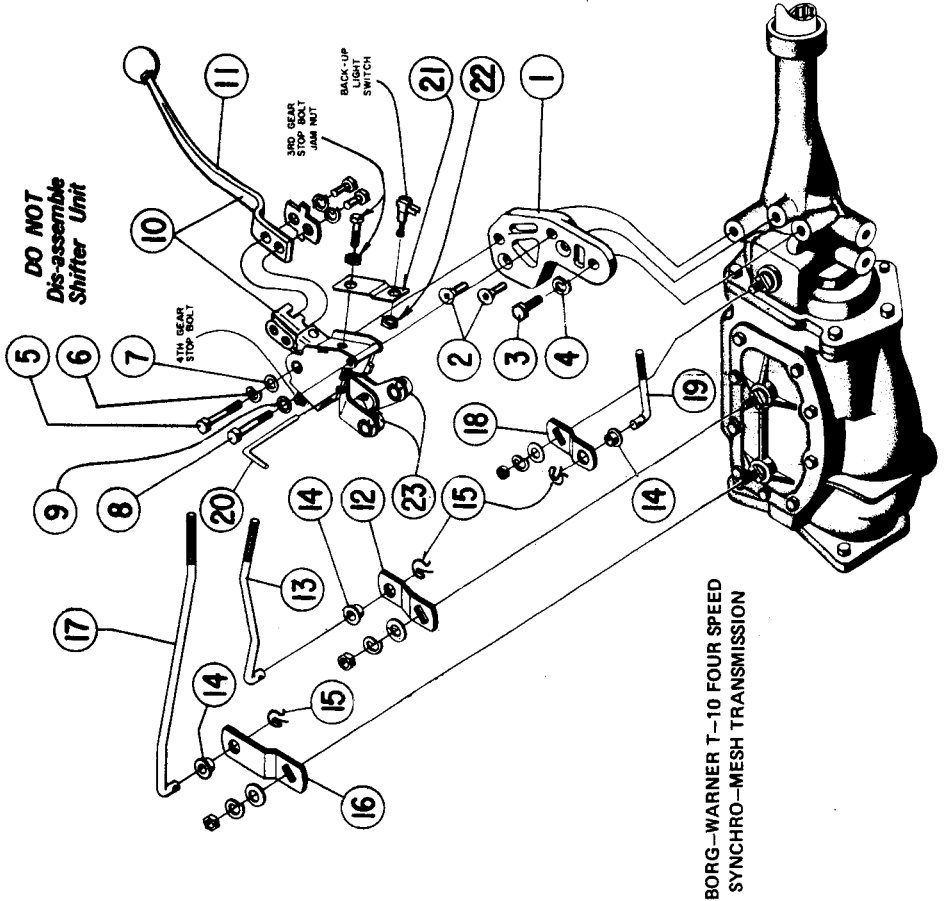

ATTENTION

Due to variations in auto manufacturing techniques, the transmission rods supplied with this kit may require slight modification in order to properly fit your vehicle. Please refer to the following instructions.

BEND RODS COLDI! - DO NOT APPLY HEAT!

CHECK NUMBERS STAMPED ON PARTS WITH NUMBERS SPECIFIED IN "CONTENTS OF KIT"

CONTENTS OF KIT

1. MOUNTING PLATE
 2. 5/16 - 18 x 1-1/4 FLAT HEAD SOCKET SCREW
 3. 5/16 - 18 x 1-1/2 BOLT
 4. 5/16" SPLIT LOCKWASHER
 5. 7/16" 14 x 3 BOLT
 6. 7/16" SPLIT LOCKWASHER
 7. 7/16" FLAT WASHER
 8. 3/8" 16 x 3 BOLT
 9. 3/8" 16 x 3 TOOTH LOCKWASHER
 10. SHIFTER ASSEMBLY
 11. STICK
 12. ARM - 1st & 2nd
 13. ROD - 1st & 2nd
 14. NYLON BUSHING
 15. SPRING CLIP
 16. ARM - 3rd & 4th
 17. ROD - 3rd & 4th
 18. ARM - REVERSE
 19. ROD - REVERSE
 20. NEUTRAL ALIGNMENT ROD
 21. BACK-UP LIGHT SWITCH BRACKET
 22. 7/16 - 20 x 1/8 SPECIAL HEX NUT
 23. ROD ADJUSTING BUTTON
- BAGGED HARDWARE - Pt. 164 3162

- Pt. 391 8789
 Pt. 226 2486
 Pt. 105 2140
 Pt. 213 2486
 Pt. 118 1681 (6)
 Pt. 97000015(6)
 Pt. 105 2458
 Pt. 213 2486
 Pt. 105 2459
 Pt. 213 2457
 Pt. 148 1725
 Pt. 117 88789
 Pt. 119 3783 (3)

Do Not Remove Transmission From Car