

COMPETITION/PLUS[®] FOUR SPEED FLOOR SHIFT

U.S. PATENT NO. 3,216,274 & NO. 3,306,126

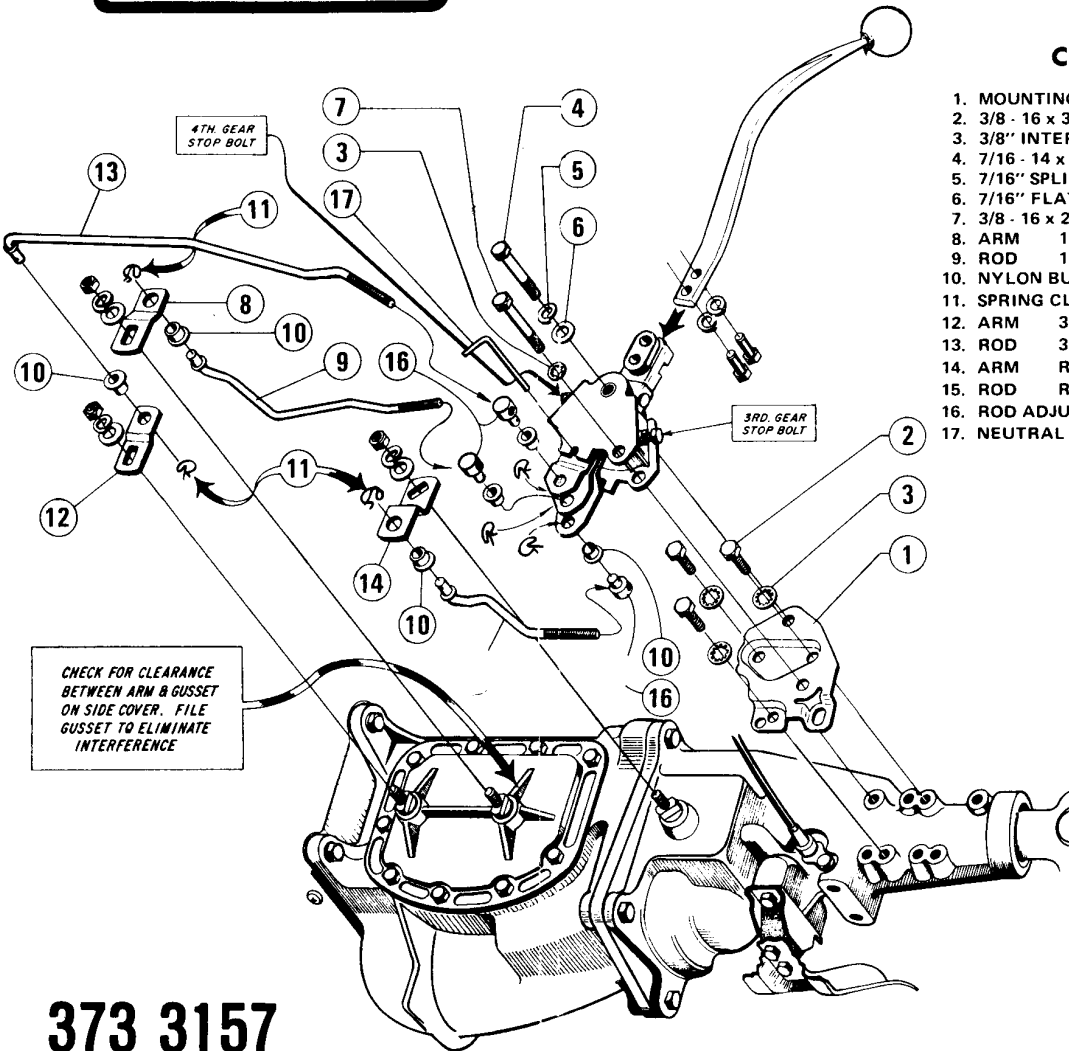

CONTENTS OF KIT

- | | |
|--|---------------------|
| 1. MOUNTING PLATE | Pt. 195 7773 |
| 2. 3/8 - 16 x 3/4 HEX HEAD CAP SCREW | (3) |
| 3. 3/8" INTERNAL TOOTH LOCKWASHER | (3) |
| 4. 7/16 - 14 x 3 HEX HEAD CAP SCREW | |
| 5. 7/16" SPLIT LOCKWASHER | |
| 6. 7/16" FLATWASHER | |
| 7. 3/8 - 16 x 2 3/4 HEX HEAD CAP SCREW | |
| 8. ARM 1 - 2 | Pt. 105 2140 |
| 9. ROD 1 - 2 | see charts |
| 10. NYLON BUSHING | Pt. 118 1681 (6) |
| 11. SPRING CLIP | Pt. 97000015 (6) |
| 12. ARM 3 - 4 | Pt. 105 2141 |
| 13. ROD 3 - 4 | see charts |
| 14. ARM REVERSE | see charts |
| 15. ROD REVERSE | see charts |
| 16. ROD ADJUSTING BUTTON | Pt. 119 3783 |
| 17. NEUTRAL ALIGNMENT GAGE PIN | Pt. 148 1725 |
| BAGGED HARDWARE | Pt. 154 3151 |

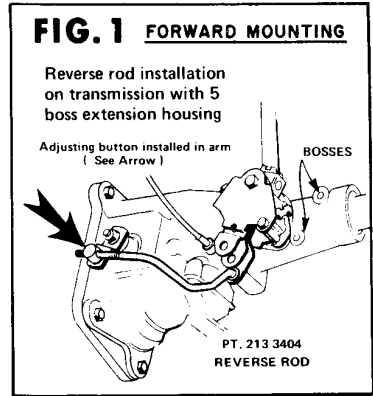

373 3157

373 4734

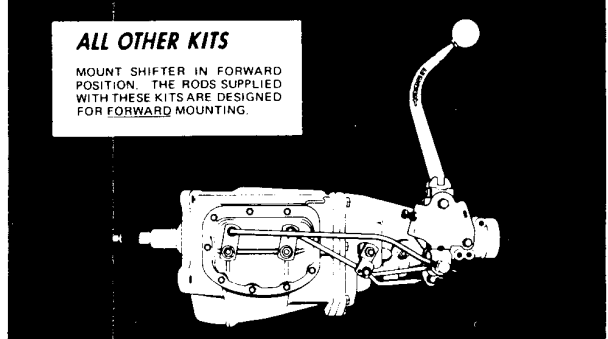
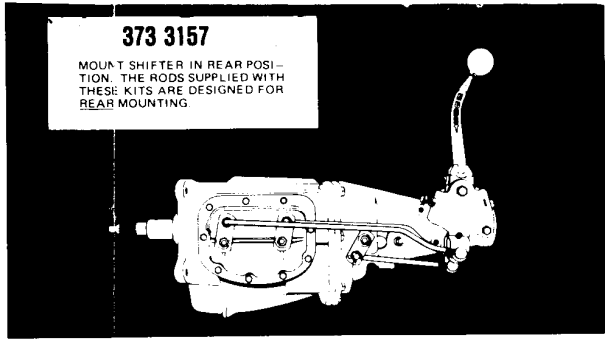

ROD AND REVERSE ARM REQUIRED FOR REAR INSTALLATIONS

RODS AND REVERSE ARM REQUIRED FOR FORWARD INSTALLATION

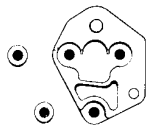

ITEM	DESCRIPTION	PART NO.
9	1 - 2 ROD	213 2144
13	3 - 4 ROD	213 2145
14	REVERSE ARM	105 1670
15	REVERSE ROD	213 2146

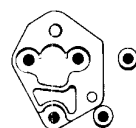

ITEM	DESCRIPTION	PART NO.
9	1 - 2 ROD	213 2138
13	3 - 4 ROD	213 2139
14	REVERSE ARM	105 2142
15	REVERSE ROD	213 3404