



# dual/gate 2

## INSTALLATION INSTRUCTIONS

### GM INSTALLATIONS

**292 0006**  
COMPLETE INSTALLATION KIT

**292 0009**  
SHIFTER ONLY

**473 0001**  
INSTALLATION PACKAGE

### FORD & CHRYSLER INSTALLATIONS

**292 0007**  
COMPLETE INSTALLATION KIT

**292 0010**  
SHIFTER ONLY

**473 0002**  
CHRYSLER INSTALLATION PACKAGE

**473 0003**  
FORD INSTALLATION PACKAGE

## WARNING

1. VEHICLES THAT HAVE STEERING COLUMN LOCK—REFER TO SEPARATE INSTRUCTION SHEET THAT IS TITLED "SAFETY IGNITION BLOCK." THIS SHEET AND THIS DEVICE ARE INCLUDED WITH THIS KIT AND **MUST** BE INSTALLED TO PREVENT THE POSSIBILITY OF TURNING THE IGNITION SWITCH OFF WHILE VEHICLE IS IN MOTION. THE STEERING COLUMN WILL LOCK WHEN THIS SWITCH IS TURNED OFF. FAILURE TO HEED THIS WARNING COULD RESULT IN ACCIDENTAL STEERING LOCK-UP WHILE VEHICLE IS IN MOTION.

### 2. EXCEPTION

#### GM Cars Equipped with Factory Floor Shift

Safety ignition block device explained under "WARNING" above, is not used in GM cars that are equipped with factory floor shift. Retain stock steering column lock activating linkage. **RETAIN STOCK TRANSMISSION ARM.** Remove stock shifter and linkage to transmission only.

#### All Other Applications

Remove all stock linkage between steering column and transmission. Remove transmission control lever from steering column. The lever at the lower end of the steering column just ahead of the firewall **MUST** be secured at the extreme end of its travel **UPWARD**. Use wire to tie it up in this position. REFER TO SEPARATE SHEET OF INSTRUCTIONS "SAFETY IGNITION BLOCK."

### 3. SHIFTER INSTALLATION

Assemble the front and rear brackets to the shifter. Refer to the exploded assembly drawing on page 2. Adjust the seat to normal driving position. Determine best position for location of shifter. Hold shifter in this position on floor and use holes in brackets as guides to drill four 1/8" holes through floor.

4. Punch mark floor at point where cable will enter through floor. Cut a 3/4" diameter hole. Remove burrs from hole.
5. Install neutral safety switch bracket on shifter—refer to exploded assembly drawing on page 2.
6. Install switch in bracket and tighten nut.
7. Assemble cable end with lever of shifter using clevis pin, washer and cotter pins as shown in detail of exploded assembly drawing on page 2.
8. Fasten cable housing to shifter frame with clamp. Hammer clamp until it is seated against ferrule. **CAUTION—AVOID SHARP BENDING OF CABLE. CABLE WILL BE PERMANENTLY DAMAGED BY ANY SHARP BENDING.**
9. Pass cable through 3/4" hole carefully. Wrap cable generously with friction tape or plastic tape where it passes through floor. Fasten shifter down to floor with four screws and flat washers—refer to exploded assembly drawing on page 2.
10. Remove stock transmission arm. Refer to drawings on page 3 to identify which arm fits your transmission. Assemble the cable pin in arm with hex-nut but do not tighten at this time. Install arm on transmission control shaft. **EXCEPTION—FORD TRANSMISSIONS.** Refer to drawing on page 3—"FORD TRANSMISSIONS ONLY". Rotate stock arm to neutral (N) position. Use a center punch to make a mark on arm and a corresponding mark on boss of transmission case. The part of the arm that is shaded in the drawing must be removed by grinding. Assemble the cable pin in the arm with hex-nut but do not tighten at this time. Install arm on transmission but do not fasten clamp bolt until you have progressed to paragraph 14—"NEUTRAL ALIGNMENT."
11. Install cable bracket on transmission—Refer to directions on page 3 for the bracket and procedure for installing.
12. Carefully route the cable around toward the cable bracket and fasten cable in bracket with cable clamp. Hammer clamp in until it is seated against ferrule.
13. Locate cable hanger approximately at the middle of the loop. Drill a 1/4" diameter hole up through floor at point where hanger joint will be. Fold clamp around cable, push split end through hole in floor. Push pointed end through split end (in drilled hole), apply force until joint snaps together and locks itself in the drilled hole.
14. **NEUTRAL ALIGNMENT**  
Refer to drawing on page 4. Perform operations explained in the drawings. Continue to paragraph 15 after completing alignment.

*text continues on page 4*

# CONTENTS OF KIT

- |   |                  |
|---|------------------|
| 1. SHIFTER ASSEMBLY - (GM APPLICATIONS)               | Pt. 292 0003     |
| 2. FRONT BRACKET                                      | Pt. 292 0004     |
| 3. 5/16 - 24 x 1/2 HEX HEAD CAP SCREW                 | Pt. 117 0144     |
| 4. 5/16 - 24 HEX NUT                                  | Pt. 215 0107 (2) |
| 5. REAR BRACKET                                       | Pt. 179 0003 (2) |
| 6. 1/4 - 20 x 1/2 SELF-TAPPING HEX HEAD SCREW         | Pt. 117 0145     |
| 7. 1/4 x 1" SELF TAPPING HEX HEAD SHEET METAL SCREW   | Pt. 272 0012 (2) |
| 8. 1/4" FLATWASHER                                    | Pt. 272 5699 (4) |
| 9. CLEVIS PIN   | Pt. 267 3478 (4) |
| 10. 1/4" FLATWASHER                                   | Pt. 189 0060     |
| 11. COTTER PIN  | Pt. 267 5712 (2) |
| 12. CABLE   | Pt. 190 3539 (2) |
| 13. CABLE MOUNTING CLIP                               | Pt. 120 5721     |
| 14. CABLE HANGER                                      | Pt. 127 5702 (2) |
| 15. CABLE PIN - (FITS ALL TRANSMISSION CONTROL ARMS)  | Pt. 126 0013     |
| 16. 3/8 - 16 SELF LOCKING HEX NUT                     | Pt. 189 0011     |
| 17. BRACKET - NEUTRAL SAFETY SWITCH                   | Pt. 179 5959     |
| 18. SWITCH - NEUTRAL SAFETY                           | Pt. 117 0146     |
| 19. #8 - 18 x 3/8 SELF TAPPING SLOTTED PAN HEAD SCREW | Pt. 248 7846     |
| 20. LAMP HOUSING                                      | Pt. 272 0013 (2) |
| 21. BULB SOCKET                                       | Pt. 157 0126     |
| 22. BULB  | Pt. 166 0002     |
| 23. PATTERN INDICATOR                                 | Pt. 166 7127     |
| 24. #10 - 32 x 1/2 SLOTTED HEAD FLAT HEAD SCREW       | Pt. 241 0004     |
| 25. #10 - 32 HEX NUT                                  | Pt. 271 0022     |
| 26. CONSOLE   | Pt. 179 3490     |
| 27. CONSOLE PLATE                                     | Pt. 129 0009     |
| 28. #10 - 24 x 1 SOCKET HEAD CAP SCREW                | Pt. 195 0140     |
| 29. KNOB  | Pt. 215 0106 (3) |
|   | Pt. 163 7200     |

BAGGED HARDWARE PACKAGES - Pt. 154 0136 & 154 0137

**NOTE:**

BAGGED HARDWARE PACKAGE, Pt. 154 0137 ALSO CONTAINS PARTS AND INSTRUCTIONS FOR INSTALLATION OF "SAFETY IGNITION BLOCK". REFER TO "WARNING" MESSAGE AT THE TOP OF THE FIRST PAGE OF THIS INSTRUCTION SHEET

REFER TO DRAWINGS AND DIRECTIONS ON PAGE 3 FOR IDENTITY AND USE OF THE FOLLOWING PARTS:

**473 0001 INSTALLATION**

GM 350, 400 & 200 (M.P.I.), TURBO-HYDRAMATIC INSTALLATIONS

- |   |                                     |
|---|-------------------------------------|
| 30. BRACKET - CABLE MOUNTING - TRANSMISSION | Pt. 117 5711                        |
| 31. 5/16 - 18 x 3/4 SOCKET HEAD CAP SCREW   | Pt. 215 0018                        |
| 32. ARM - TRANSMISSION CONTROL SHAFT        | <del>Pt. 105 0062</del><br>105 0080 |

**473 0002**

CHRYSLER TORQUEFLITE TRANSMISSION INSTALLATIONS

- |   |                                     |
|---|-------------------------------------|
| 33. BRACKET - CABLE MOUNTING - TRANSMISSION | Pt. 117 0094                        |
| 34. ARM - TRANSMISSION CONTROL SHAFT        | <del>Pt. 105 0062</del><br>105 0080 |
| 35. 5/16" FLATWASHER                        | Pt. 267 3481 (4)                    |

**473 0003**

FORD C-4 AND C-6 TRANSMISSION INSTALLATIONS

- |  |              |
|--|--------------|
| 36. BRACKET - CABLE MOUNTING - C-4 TRANSMISSIONS | Pt. 117 0037 |
| 37. BRACKET - CABLE MOUNTING - C-6 TRANSMISSIONS | Pt. 117 0038 |
| 38. ARM - TRANSMISSION CONTROL SHAFT             | Pt. 105 0062 |
| 39. 1/4 - 28 x 1 - 1/2 HEX HEAD CAP SCREW        | Pt. 215 4052 |
| 40. 1/4" SPLIT LOCKWASHER                        | Pt. 267 3471 |
| 41. 1/4 - 28 SQUARE NUT                          | Pt. 179 0056 |

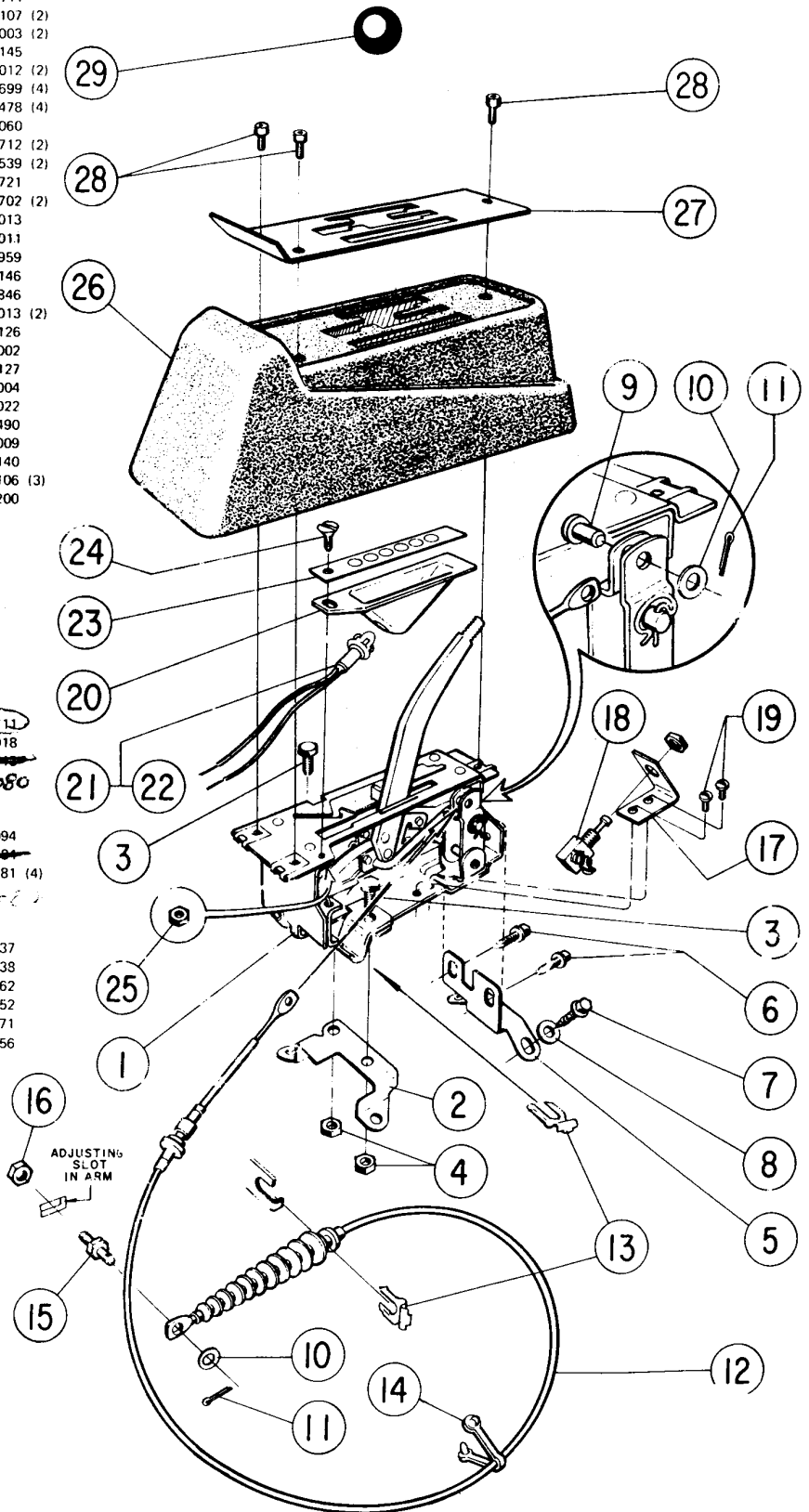

© 1980 by Hurst Performance, Inc.

# GM INSTALLATIONS

**CARS WITH FACTORY FLOOR SHIFT ONLY.**

RETAIN STOCK CONTROL ARM. CONNECT CABLE END TO STOCK ARM. OPERATION OF SAFETY STEERING COLUMN LOCK, BACK-UP LIGHT SWITCH AND NEUTRAL SAFETY SWITCH IS MAINTAINED.

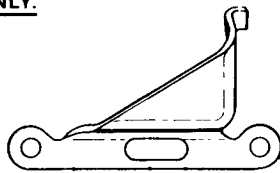

BRACKET  
PT. 117 5711

ALL GM INSTALLATIONS USE THIS BRACKET - PT. 117 5711. REFER TO DRAWINGS BELOW FOR METHOD OF FASTENING.

## 400 TURBO-HYDRAMATIC

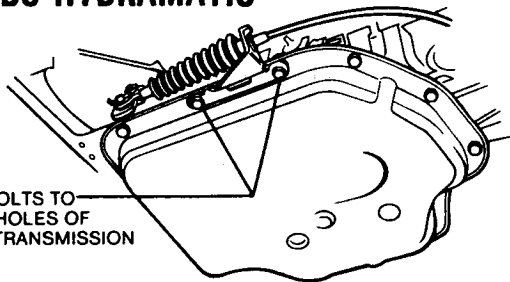

USE STOCK BOLTS TO FASTEN END HOLES OF BRACKET TO TRANSMISSION

## 350 TURBO-HYDRAMATIC

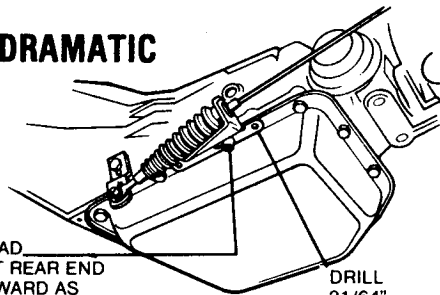

INSTALL BRACKET WITH 5/16-18 x 3/4 SOCKET-HEAD CAP SCREW LOCATED AT REAR END OF SLOT (BRACKET FORWARD AS FAR AS POSSIBLE).

DRILL 21/64" DIAMETER HOLE THRU REAR MTG. HOLE

## 350 TURBO-HYDRAMATIC AND 200 METRIC TURBO HYDRAMATIC

AFTER INSTALLATION IS COMPLETED, DRILL A 21/64" DIAMETER HOLE THROUGH THE TRANSMISSION CASE THROUGH REAR MOUNTING HOLE IN BRACKET (USE BRACKET HOLE AS DRILL GUIDE). FASTEN REAR END OF BRACKET TO TRANSMISSION WITH A SUITABLE 5/16" DIAMETER BOLT, LOCKWASHER AND NUT.

## 200 METRIC TURBO-HYDRAMATIC

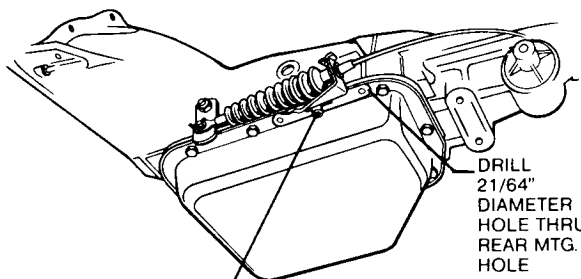

DRILL 21/64" DIAMETER HOLE THRU REAR MTG. HOLE

INSTALL BRACKET WITH 5/16-18x3/4 SOCKET-HEAD CAP SCREW. LOCATE SCREW AT MIDDLE OF SLOT. THE LOCATION CAN BE ADJUSTED WHEN YOU PERFORM "NEUTRAL ALIGNMENT" OPERATION DESCRIBED ON PAGE 4.

# CHRYSLER 904 & 727 TORQUEFLITE

BOLT, LOCKWASHER AND SQUARE NUT ARE FROM STOCK TRANSMISSION ARM.

904 TRANSMISSION IS SHOWN. INSTALLATION ON 727 TRANSMISSION IS IDENTICAL.

CABLE APPROACHES TRANSMISSION FROM FRONT OF VEHICLE.

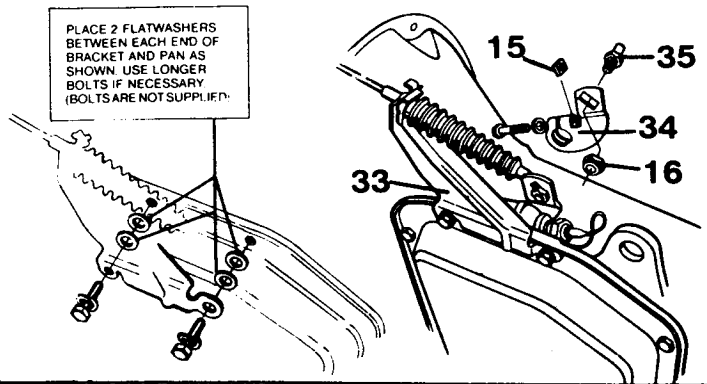

PLACE 2 FLATWASHERS BETWEEN EACH END OF BRACKET AND PAN AS SHOWN. USE LONGER BOLTS IF NECESSARY (BOLTS ARE NOT SUPPLIED).

# FORD INSTALLATIONS

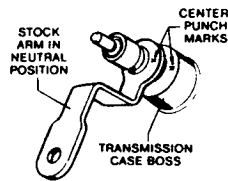

ROTATE STOCK ARM TO "N" (NEUTRAL). USE CENTER-PUNCH TO MAKE MARK ON ARM AND CORRESPONDING MARK ON TRANSMISSION CASE BOSS.

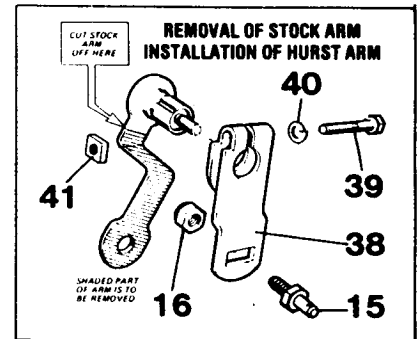

CUT SHADED PART OF STOCK ARM OFF. INSTALL HURST ARM ON SHAFT (CABLE PIN LOOSELY INSTALLED IN ARM). DO NOT TIGHTEN CLAMP BOLT. MOVE SHIFTER STICK TO "N" (NEUTRAL). PLACE CABLE END ON PIN. ADJUST ARM TO POSITION WHERE PIN IS AT CENTER OF SLOT. TIGHTEN CLAMP BOLT. TIGHTEN NUT ON PIN.

## FORD C-4

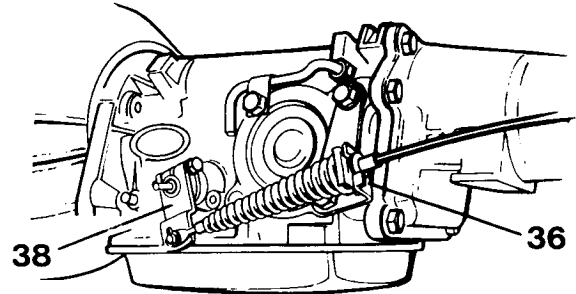

## FORD C-6

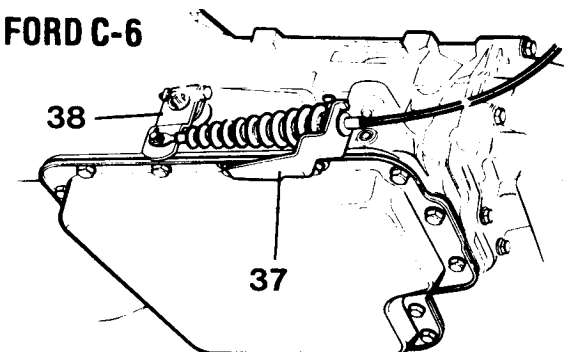

CABLE PIN ADJUST-  
ALL INSTALLATIONS

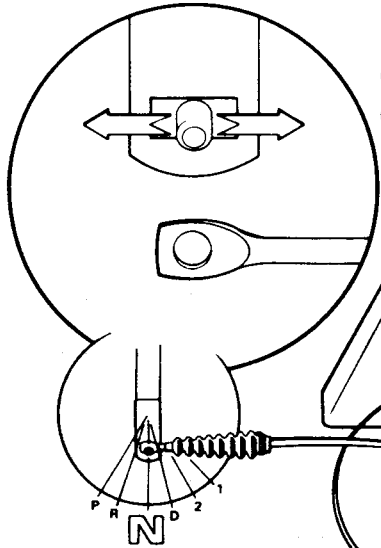

ALL INSTALLATIONS  
EXCEPT CHRYSLER

## ALIGNMENT PROCEDURE

- ① POSITION SHIFTER STICK AT "N" (NEUTRAL)
- ② POSITION TRANSMISSION ARM AT "N" (NEUTRAL)
- ③ ADJUST CABLE PIN IN SLOT IN ARM AS SEEN IN ENLARGED DRAWING.
- ④ FASTEN CABLE END ON PIN WITH FLAT WASHER AND COTTER PIN

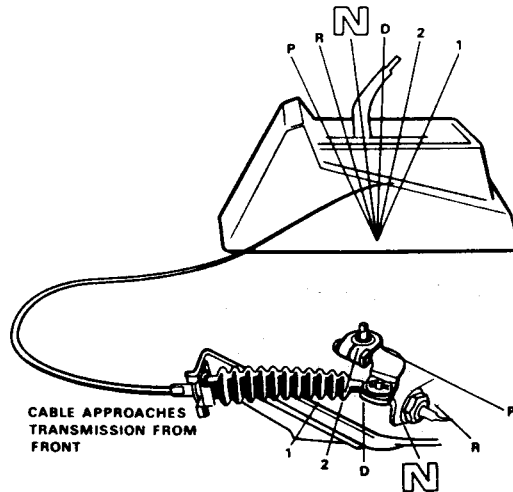
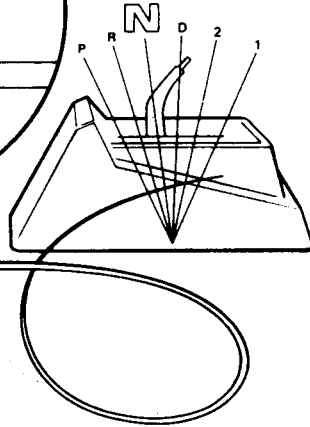

CABLE APPROACHES  
TRANSMISSION FROM  
FRONT

*text continued from page 1*

15. Disconnect the stock neutral start switch wires from terminals on stock switch. Connect these wires to the neutral safety switch on the shifter. Additional wire may be required.
16. Connect center lead of indicator lamp to a convenient point of instrument panel light circuit. Connect other lead to frame of shifter. Place lamp housing in opening in shifter frame. Push lamp socket into hole in lamp housing. Place pattern indicator on top of housing. Fasten indicator and lamp housing to shifter with the slotted flat head screw and hex-nut.

17. TEST PERFORMANCE OF SHIFTER. Car must be on ground in a safe position. Hold brake pedal on while testing. Move stick to all positions to check operation of starter motor. Starter motor is to operate ONLY when stick is in "PARK" (P) position. If starter motor can be energized when stick is in any position other than "PARK" (P), adjust the neutral safety switch bracket by bending it down toward the floor. Check transmission operation in all gear positions (P-R-N-D-2-1). Final adjustment, if necessary, is to be made at the cable pin in the slot in the transmission arm.
18. Refer to last drawing on page 4. Trim and install console over shifter as directed.
19. Fasten console and console plate to top of shifter frame with three socket head cap screws.

## INSTALLATION OF CONSOLE

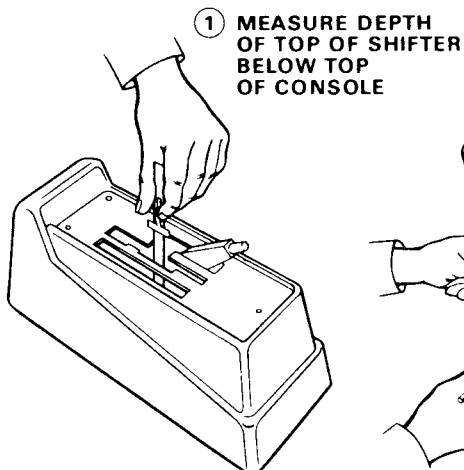

- ① MEASURE DEPTH  
OF TOP OF SHIFTER  
BELOW TOP  
OF CONSOLE

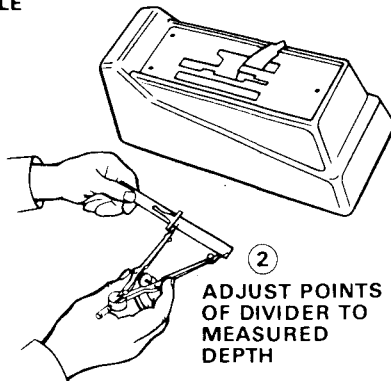

- ② ADJUST POINTS  
OF DIVIDER TO  
MEASURED  
DEPTH

- ③ SCRIBE CONTOURS OF FLOOR  
ALONG SIDE OF CONSOLE AS  
SHOWN. MAINTAIN DIVIDER IN  
PERPENDICULAR PLANE WHILE  
SCRIBING.

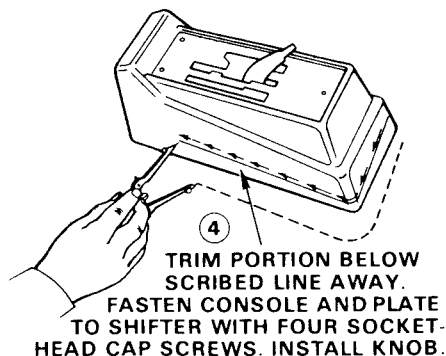

- ④ TRIM PORTION BELOW  
SCRIBED LINE AWAY.  
FASTEN CONSOLE AND PLATE  
TO SHIFTER WITH FOUR SOCKET-  
HEAD CAP SCREWS. INSTALL KNOB.

page 4